

A-SitStandSWSPs
compatible with Arjo Sara® Plus



Outer side: Label indicates size



Inner side: Safety belt with texture fabric to prevent slippage.

Size/Color Tab	Waist Range*	SWL
M	36" - 50"	660LB/ 300 KG
L	40" - 57"	
X	44" - 69"	

*if in doubt, step down one size.



Have patient lean (or assist) slightly forward and place sling down to patient's lower back.

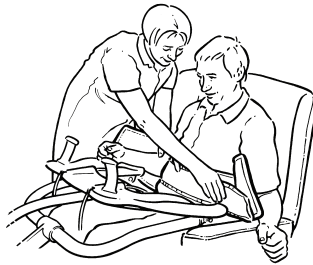

Fasten and attach strap to buckle of belt around patient by feeding the sling webbing through cinch buckle. Belt should be snug and comfortable.

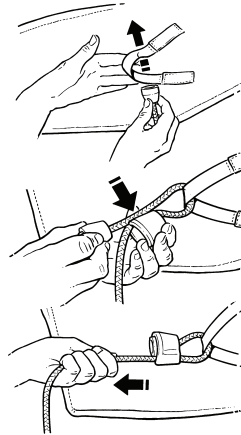

Bring SARA® Plus mobile lift close to patient, take each adjustment cord and attach to the sling through the loops

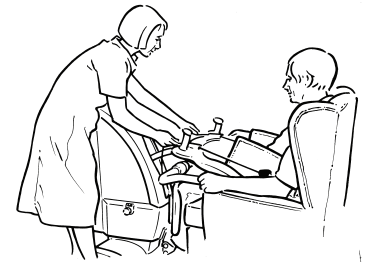

Once both cords are correctly attached, adjust cords equally so that all slack is taken up in both cords. The back of the sling should support the patient comfortably and securely. Lock adjustment cords down into the cord retaining cleats.

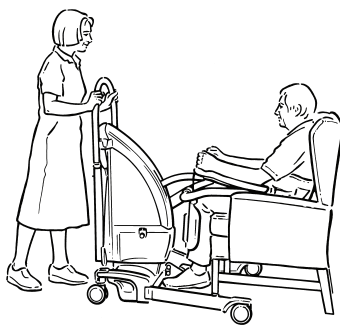

The sling should support the patient but should not pull the patient forward too much. If patient is able, encourage the patient to hold onto the 'support arms' on SARA® Plus with one or both hands. Patient is ready to be lifted.

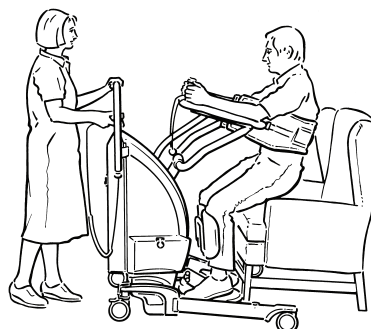

Try to have the patient assist in raising from chair or keep themselves steady. Operate lift button to raise patient to a height that is comfortable.

Cleaning Instructions

- Wipe with approved hospital disinfectant between patients.
- DO NOT soak in chlorine based bleach solution
- DO NOT LAUNDER